

Map

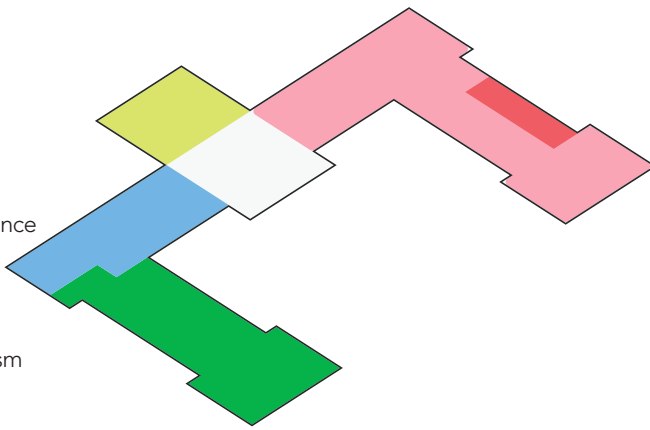

3

- Asian Art
- European Art 1100–1500
Medieval to Early Renaissance
- Arms & Armor
- European Art 1500–1850
Renaissance to Romanticism
- American Art
Period Rooms



2

- American Art 1850–1950
- Special Exhibitions
- Prints, Drawings,
Photographs
- European Art 1850–1900
Impressionism
- Modern &
Contemporary Art

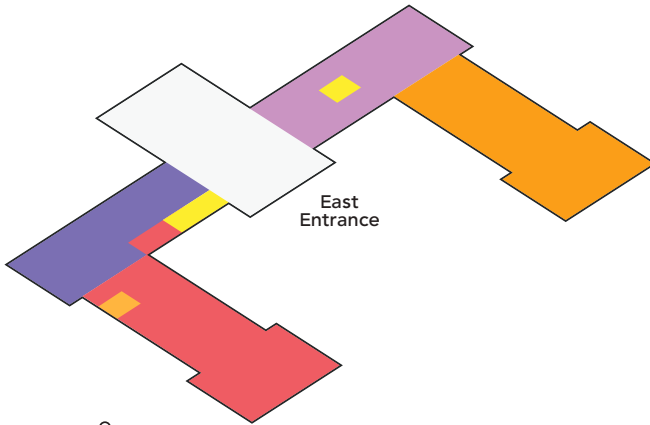

1

- American Art 1650–1850
- Modern &
Contemporary Art
- Prints, Drawings,
Photographs

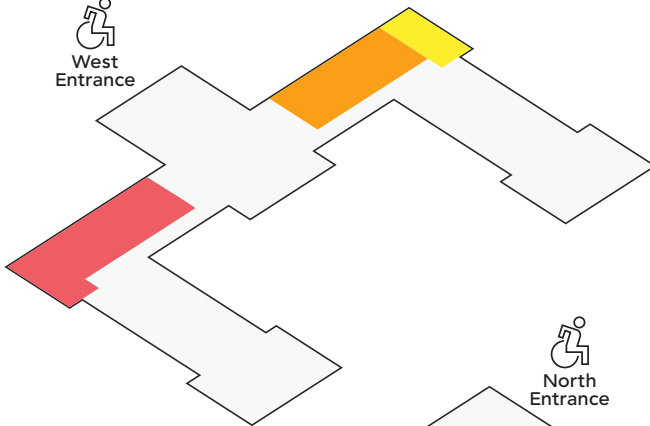

G

- Sculpture & Installations

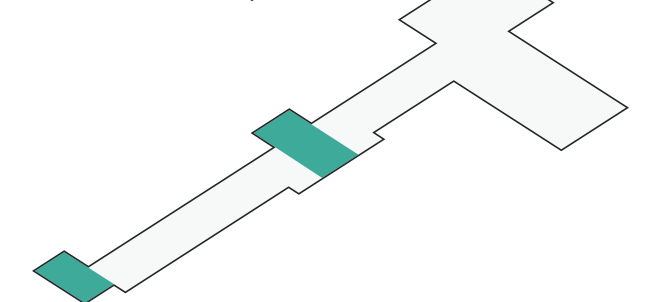

Don't know where to begin?



Here are 10 of our greatest hits. To find them in the galleries, page to the floor maps and look for this ☆

Or scan here to search our collection online



Wampum Belt
Likely Lenape women artists
Gallery 100



Fountain
Marcel Duchamp
Gallery 282



Portrait of Yarrow Mamout
Charles Willson Peale
Gallery 104



The Last Drop
Judith Leyster
Gallery 364



The Annunciation
Henry Ossawa Tanner
Gallery 211



Horse and Man Armors
Wilhelm von Worms (horse) & Matthes Deutsch (man)
Gallery 347



Japanese Footbridge
Claude Monet
Gallery 261



The Crucifixion
Rogier van der Weyden
Gallery 306



Sugar Cane
Diego Rivera
Gallery 273



Japanese Teahouse and Garden
Ōgi Rodō
Gallery 344

G



Williams Forum



Fox Hall



Art Kids Studio

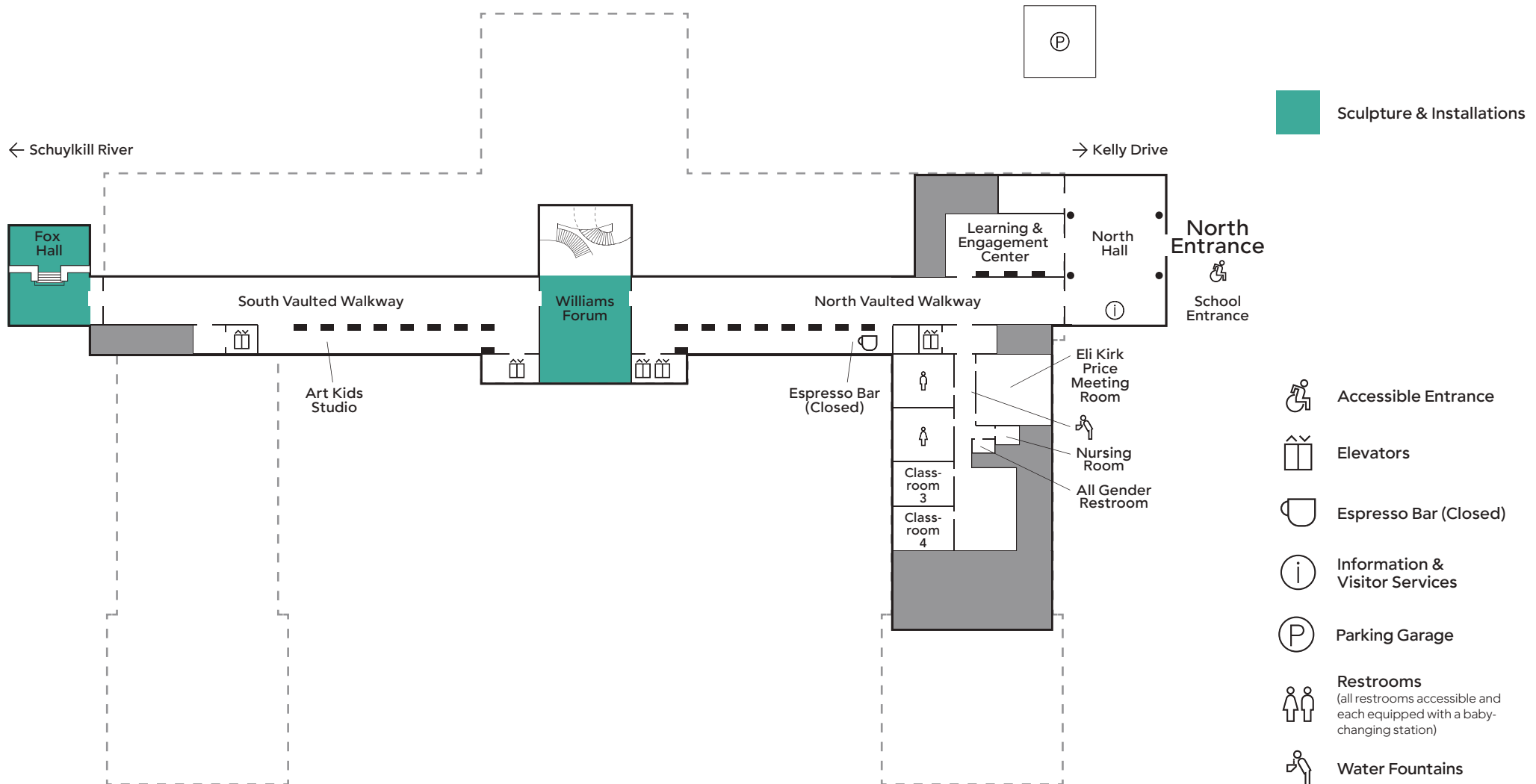

1

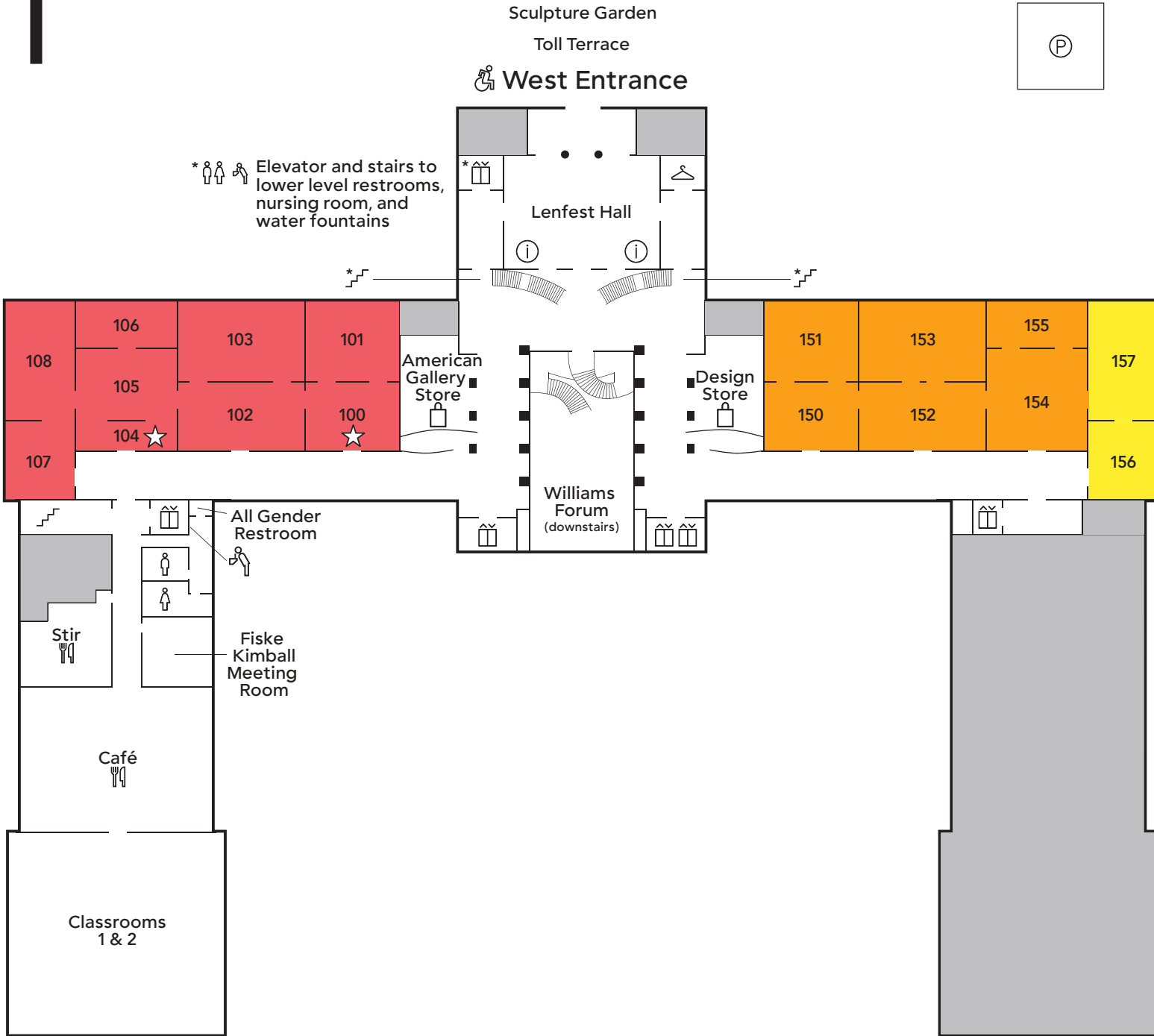

Must-See Artworks



Gallery 100



Gallery 104

- American Art
1650 – 1850
- Modern & Contemporary Art
- Prints, Drawings, Photographs

- Must-See Artworks
- Accessible Entrance
- Coat Check
- Elevators
- Information & Visitor Services
- Museum Stores
- Parking Garage
- Restaurant & Café
- Restrooms
(all restrooms accessible and each equipped with a baby-changing station)
- Stairs
- Water Fountains

2

Must-See Artworks



Gallery 211



Gallery 261



Gallery 273



Gallery 282



- American Art 1850–1950
- Special Exhibitions
- Prints, Drawings, Photographs
- European Art 1850–1900 Impressionism
- Modern & Contemporary Art
- Must-See Artworks
- Accessible Lift
- Balcony Café
- Diana Sculpture
- Elevators
- Information & Visitor Services
- Restrooms
(all restrooms accessible and each equipped with a baby-changing station)
- Stairs

3

Must-See Artworks



Gallery 344



Gallery 306



Gallery 347



Gallery 364

Sculpture Garden Vista

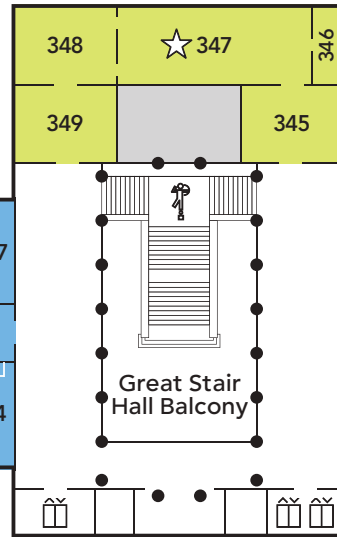

Parkway Vista



- Asian Art
- European Art 1100–1500
Medieval to Early Renaissance
- Arms & Armor
- European Art 1500–1850
Renaissance to Romanticism
- American Art
Period Rooms

Must-See Artworks

Diana Sculpture

Elevators

Restrooms
(all restrooms accessible and each equipped with a baby-changing station)

Stairs

Visitor Information

Enjoy two-day access to this museum, and the Rodin Museum, with a general admission ticket

Dine

Check website for hours

Café

Family friendly, fast-casual dining
First floor

Stir

Table service with signature dishes and a variety of craft beverages
First floor

Balcony Café

Espresso drinks, beer, wine, and grab-and-go snacks
Second floor

While You're Here



Help us protect the art— please do not touch



Store your umbrellas and oversize items at our free coat checks



No food or drink in the galleries



Free Wi-Fi (wifipma)



Have you validated your parking ticket? Stop by any Visitor Services desk



Flash is not permitted, but take lots of pictures, and don't forget to tag us @philamuseum



Audio guides available at any Visitor Services desk or scan below



Scan below for a calendar of talks, tours, and exhibitions



Shop

Online at store.philamuseum.org

Design Store

Local & global decor, books, and gifts for lovers of modern design
First floor

American Gallery Store

Local decor, jewelry, books, and gifts inspired by our American art galleries
First floor

Let's Get Social

philamuseum.org
[@philamuseum](https://twitter.com/philamuseum)



Philadelphia
Museum of **Art**

During your visit, you may be photographed or filmed by museum staff. We may use these images in signage, printed materials, and online for any purpose, commercial or otherwise

Cover: on display in gallery 321. *Heluo with Self-Portrait* (detail), 2023, by Ai Weiwei (Courtesy of Ai Weiwei Studio)
Williams Forum: Steve Hall © Hall + Merrick Photographers. Art Kids Studio: photo by Albert Yee