

# Map

Carnegie  
Museums of  
Art and  
Natural History

# Floor 0

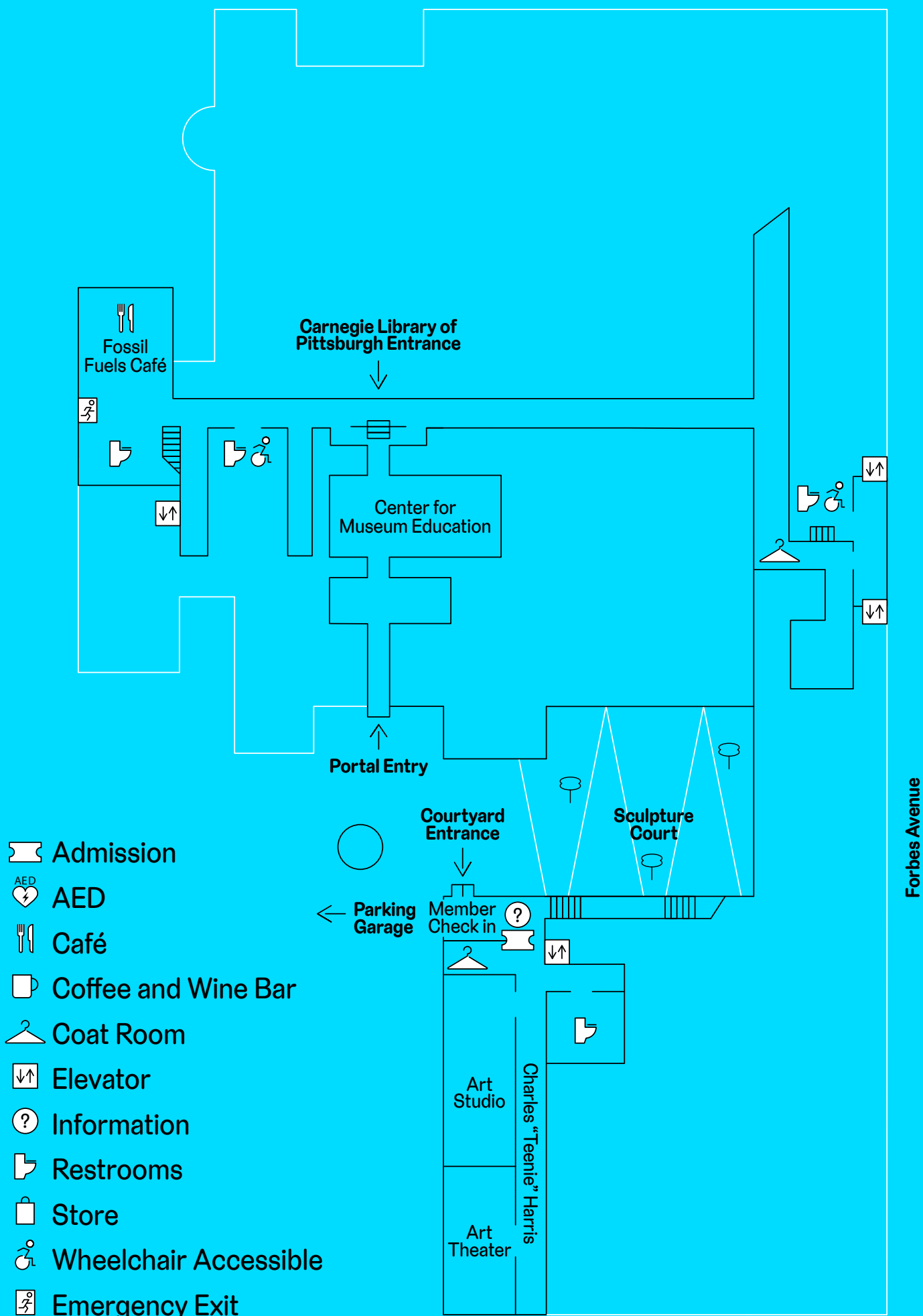

# Floor 1

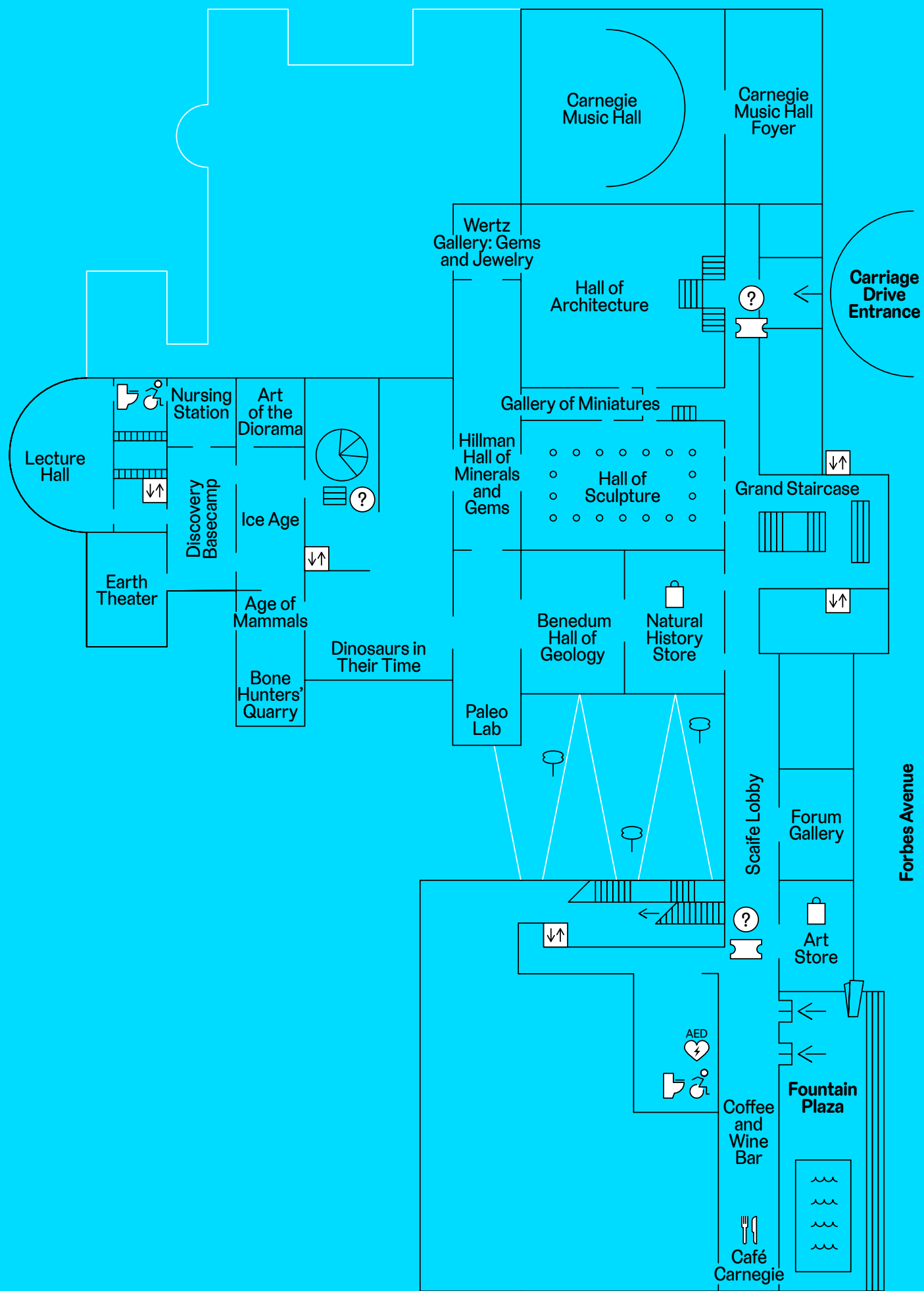

# Floor 2

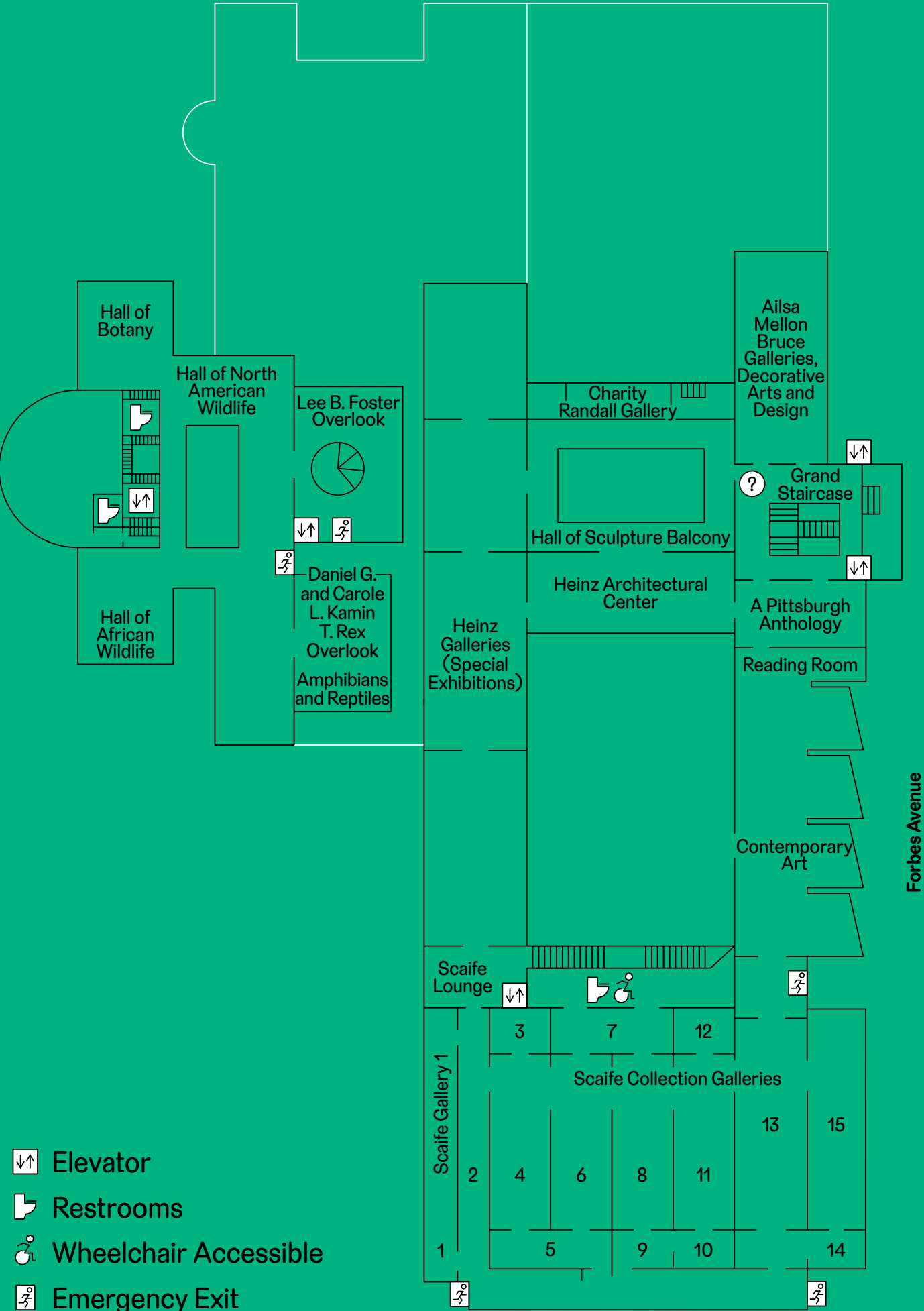

# Floor 3

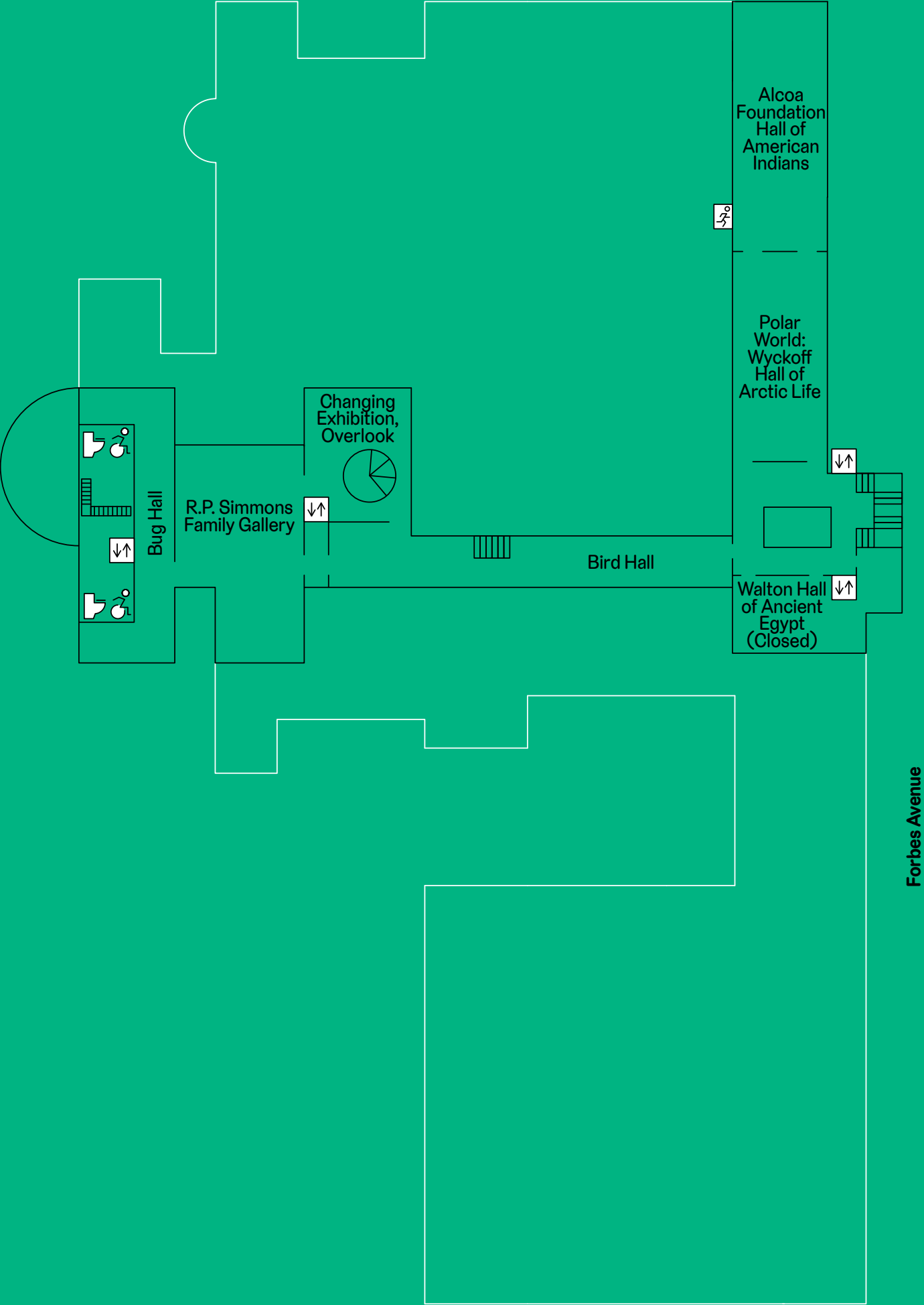

# Visitor Information

---

## Gallery Closures

Our museums are always changing! Spaces occasionally close for special events or gallery improvements. Please inquire at the admission desks if you have questions.

## Health and Safety Policies

The following are not permitted:

- Smoking, chewing, or using vapor devices inside the museum or within 20 feet of the entrances.
- Bringing a weapon, firearm, or hazardous materials on museum property.
- Rude, aggressive, or abusive behaviors.

## Visitor Guidelines

It takes all of us to care for the artworks and collections on display. **Please do not:**

- Eat or drink in the galleries.
- Touch the artwork or collections.
- Leave children under the age of 12 unaccompanied by an adult.
- Run, push, or shove.
- Carry children on your shoulders.
- Carry an umbrella in the galleries. Coat room and lockers are available.
- Carry a backpack or backpack-style baby carrier on your back in the galleries. You are permitted to carry a backpack on your front or side.

## Accessibility

The museums are working to make programs and exhibitions accessible to all visitors. If you have a question about any accommodation, please inquire at the admission desks.

## Strollers and Wheelchairs

- We provide wheelchairs and strollers, or you're welcome to bring your own.
- Strollers and wheelchairs may have limited access in certain galleries.

## Photography

- Still photography is permitted for personal, noncommercial use only.
- Flash, tripods, camera bags, and camera extension poles are not allowed.
- Maintain at least two feet from artworks.
- Video is not permitted in Carnegie Museum of Art galleries.

## Support

Carnegie Museums of Pittsburgh are supported in part by the taxpayers of Allegheny County through a public grant from Allegheny Regional Asset District (RAD).



# Dining

---

## **Café Carnegie**

Café Carnegie features a full-service dining area and a walk-up espresso and wine bar for a relaxing break during a museum visit.

### **Café Carnegie—Coffee and Wine Bar Hours**

Monday	9 a.m.–5 p.m.
Tuesday	Closed*
Wednesday	9 a.m.–5 p.m.
Thursday	9 a.m.–8 p.m.
Friday	9 a.m.–5 p.m.
Saturday and Sunday	9 a.m.–5 p.m.
*Open Tuesday in Summer from 9 a.m.–5 p.m.	

### **Café Carnegie—Dining Room Hours**

Monday	11 a.m.–3 p.m.
Tuesday	Closed*
Wednesday	11 a.m.–3 p.m.
Thursday	11 a.m.–3 p.m. and 5 p.m.–8 p.m.
Friday	11 a.m.–3 p.m.
Saturday and Sunday	11 a.m.–3 p.m.
*Open Tuesday in Summer from 11 a.m.–5 p.m.	

## **Fossil Fuels Café**

Hungry but want to see more museum? Stop by Fossil Fuels to make your own sandwiches or salads and get grab-and-go food.  
Open 10 a.m.–4 p.m.

# Shopping

---

The stores at Carnegie Museums of Art and Natural History offer unique products inspired by museum exhibitions and programming. Shop artist-designed merchandise, children's crafts, and a wide selection of art and design books at Carnegie Museum of Art, and explore wildlife dioramas, dinosaurs, toys and more at Carnegie Museum of Natural History.

# Membership

---

Become a member! Apply today's admission to a membership and visit the four Carnegie Museums all year long. All members receive free general admission, invitations to members-only events and programming, free reciprocal admission at 300+ ASTC museums and science centers, special discounts, and more.

# Programs

---

There is always something new to experience at the museums! Ask us how you can engage today, or visit our websites for a full calendar of events.

# Welcome

---

## Museum Hours

Monday	10 a.m.–5 p.m.
Tuesday	Closed*
Wednesday	10 a.m.–5 p.m.
Thursday	10 a.m.–8 p.m.
Friday	10 a.m.–5 p.m.
Saturday and Sunday	10 a.m.–5 p.m.

- Discounted admission after 3 p.m. on weekdays.
- \*Between Memorial Day and Labor Day, the museum is open on Tuesdays from 10 a.m.–5 p.m.
- Closed on Holidays: New Year's Day, Easter, Thanksgiving, and Christmas.

## Questions or Feedback

For questions or feedback about your visit, please email [visitorservices@carnegiemuseums.org](mailto:visitorservices@carnegiemuseums.org) or call 412.622.3131.

## Carnegie Museum of Art

Instagram: [@carnegiemuseumofart](https://www.instagram.com/carnegiemuseumofart)

Twitter: [@cmoa](https://twitter.com/cmoa)

Facebook, YouTube, LinkedIn: Carnegie Museum of Art

## Carnegie Museum of Natural History

Facebook, YouTube, Instagram, TikTok: [@carnegiemnh](https://www.instagram.com/carnegiemnh)

4400 Forbes Avenue  
Pittsburgh, PA 15213  
[carnegieart.org](https://carnegieart.org)  
[carnegiemnh.org](https://carnegiemnh.org)